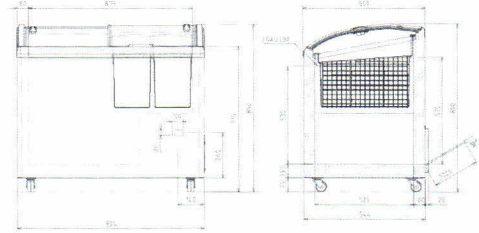

Chest freezer

SCR-PT101GTH(EX)-BF

-25°C

Thailand

Effective capacity
206L

| Model | | SCR-PT101GTH(EX)-BF | | | | | | | | | | |
|-----------------------|------------------------|----------------------------------|--|-----------|-----|----------------------|-------------|----------------------|--|--------------------------|---------------|--|
| Operating temperature | | -25°C (ambient temperature 32°C) | | | | | Compressor | | Hermetic type | | | |
| Case body | Dimensions (mm) | W | D | H | | Refrigeration system | Refrigerant | | R134a | | | |
| | | External | 1000 | 650 (+20) | 890 | | Evaporator | | Copper tube wrapped on inner liner | | | |
| | Internal | 875 | 525 | (450/500) | | | Condenser | | Skin-condenser & Tube natural convection | | | |
| | Effective capacity (L) | | 206 | | | | | Temperature control | | Mechanical thermostat | | |
| | Outer case material | | Bake on acryl finish on steel sheet | | | | | Defrost type | | Manual off-cycle defrost | | |
| | Inner case material | | Bake on acryl finish on steel sheet | | | | | Lighting | | No | | |
| | Door type | | Low-E Curved glasses panel (slide glass) | | | | | Weight (kg) | | 61 | | |
| | Basket | | PE powder coated basket x 2 | | | | | Electrical parameter | Power source | Operation power | Defrost power | |
| | | | | | | | | | 1φ, 220V, 50Hz | ND | ND | |

Chest freezer

SCR-PT126G(EX)-BF

-25°C

Thailand

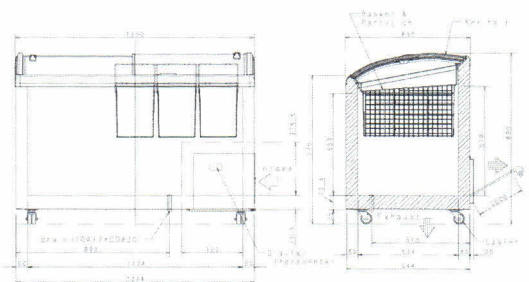
Effective capacity
278L

| Model | | SCR-PT126G(EX)-BF | | | | | | | | | | |
|-----------------------|------------------------|----------------------------------|--|-----------|-----|----------------------|-------------|----------------------|--|--------------------------|---------------|--|
| Operating temperature | | -25°C (ambient temperature 32°C) | | | | | Compressor | | Hermetic type | | | |
| Case body | Dimensions (mm) | W | D | H | | Refrigeration system | Refrigerant | | R134a | | | |
| | | External | 1250 | 650 (+20) | 890 | | Evaporator | | Copper tube wrapped on inner liner | | | |
| | Internal | 1125 | 525 | (450/500) | | | Condenser | | Skin-condenser & Tube natural convection | | | |
| | Effective capacity (L) | | 278 | | | | | Temperature control | | Mechanical thermostat | | |
| | Outer case material | | Bake on acryl finish on steel sheet | | | | | Defrost type | | Manual off-cycle defrost | | |
| | Inner case material | | Bake on acryl finish on steel sheet | | | | | Lighting | | No | | |
| | Door type | | Low-E Curved glasses panel (slide glass) | | | | | Weight (kg) | | 69 | | |
| | Basket | | PE powder coated basket x 3 | | | | | Electrical parameter | Power source | Operation power | Defrost power | |
| | | | | | | | | | 1φ, 220V, 50Hz | ND | ND | |